

BANBURY HEIGHTS

SINGLE FAMILY HOME SITES

- **Available Lots:** 74
- **Lot Sizes:** 8,759 – 21,310 sq. ft.
- **Lot Price Range:** \$89,900 – \$95,500
- **Municipality:** Village of Windsor, WI
- **School District:** Deforest Area Schools
- Sewer and Water
- Protective Covenants
- Internal Multi-Use Sidewalks
- External Multi-Use Trail Connections

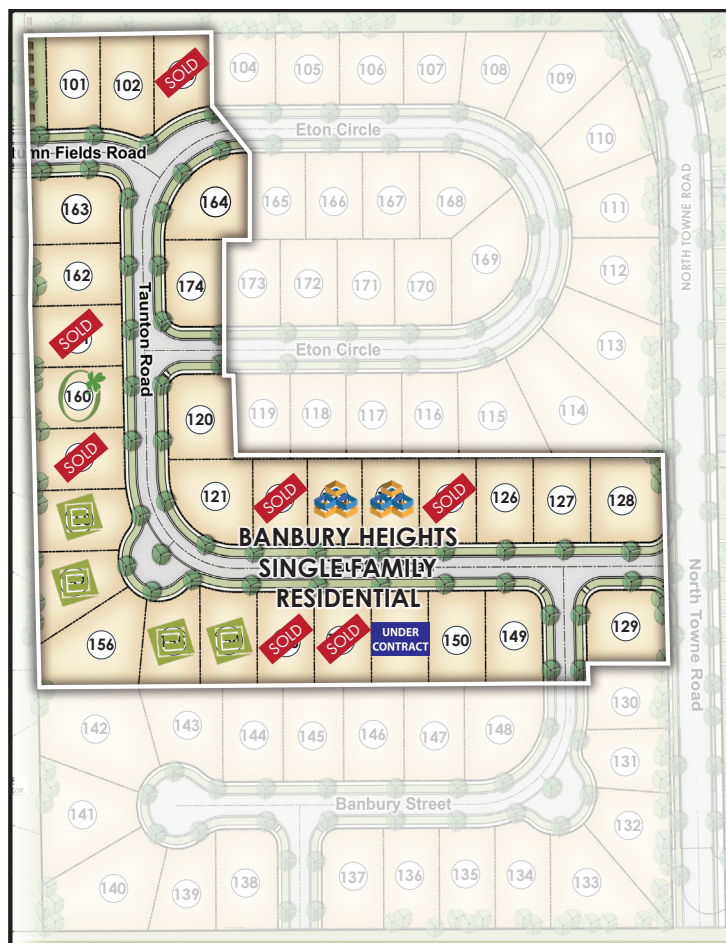

CONTACT



Bob Winding | First Weber
windingb@firstweber.com
608.692.9400

Banbury Heights is a single family subdivision that connects the surrounding neighborhoods to the Windsor Crossing development. A total of 74 home sites comprise the single family subdivision. 30 home sites are currently available in Phases 1 and 2a, and the remaining home sites will be phased out through the following years to compliment the timeline of construction for the rest of the development

Windsor Crossing

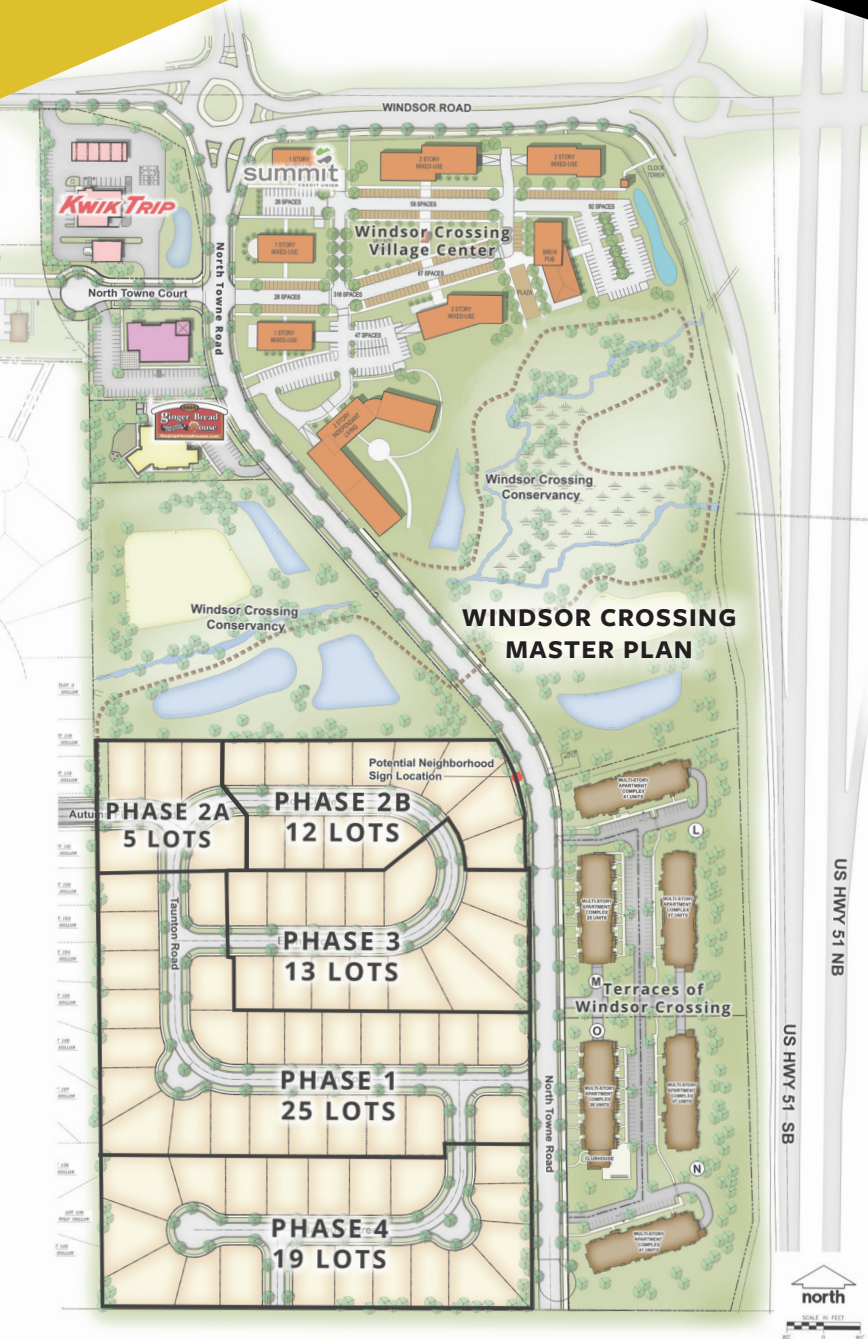

Windsor Crossing is a mixed-use development comprised of approximately 85 acres in the southwest quadrant of US Highway 51 and Windsor Road in Dane County, WI. The northern 27 acres are planned for commercial and retail use. Immediately to the south of the commercial area is a conservancy containing the storm water management facilities for the development, along with a trail system that connects the commercial area with the residential housing component. Windsor Crossing will have 74 single-family residential home sites located south of the conservancy area and west of North Towne Road. Additionally, there are 228 multi-family housing units just west of the single-family home sites and east of US Highway 51.

Nearby site amenities include but are not limited to: Cherokee Marsh, Lake Windsor & Lake Windsor Country Club, Fireman's Park, Upper Yahara River Environmental Corridor, Token Creek Conservancy, Linde Fields Soccer Complex, Northern Corridor Park, extensive multi-trail system and multiple retail and restaurant options.

CONTACT



Bob Winding | First Weber
windingb@firstweber.com
608.692.9400



WINDSOR CROSSING REGIONAL CONTEXT MAP